

GP Component

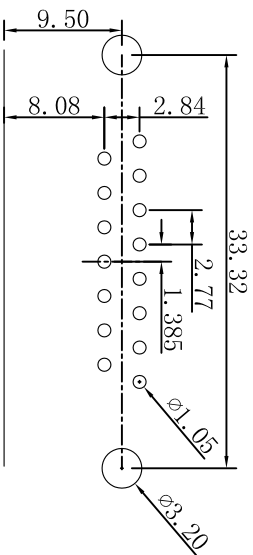

PCB Layout

Specification Type (1:2)

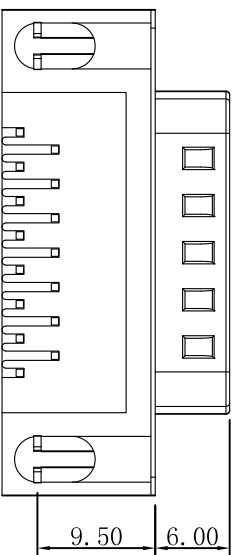
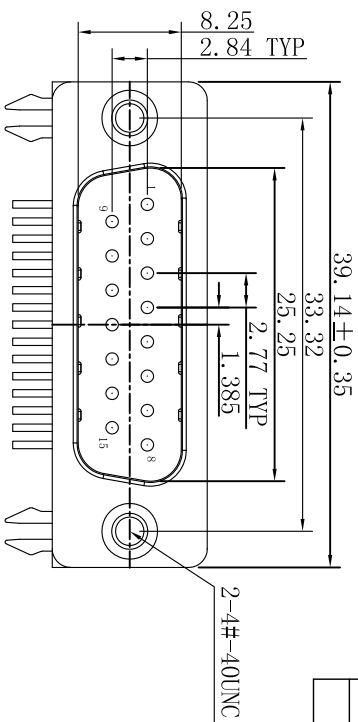
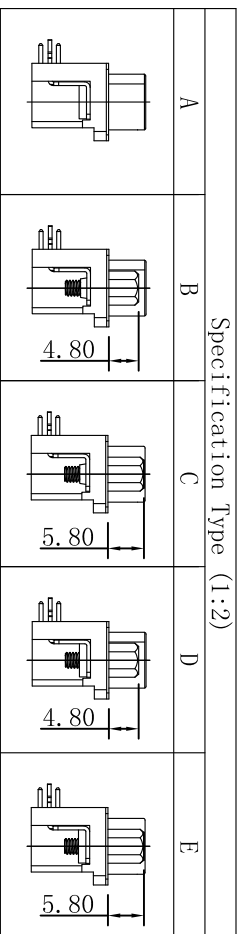

REV.	ECN NO.	LOCATIONS	DESCRIPTION	DATE	DESIGN
AO			原始版本(INITIAL EDITION)	2020.12.15	m t

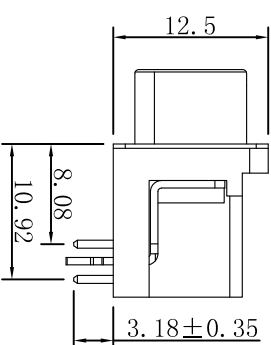

CHARACTERISTICS:

1. RATED VOLTAGE: 250V AC CD
2. RATED CURRENT: 3.0AMP
3. CONTACT RESISTANCE: 30mΩ Max.
4. INSULATION RESISTANCE: 1000 MΩ MIN. 500V DC
5. Electric Pressure: Keeping 60 second in AC 500V/1mA
6. Operating temperature: -55°C~105°C
7. INSERTION/EXTRACTION FORCE PER CONTACT: 5.0Kg Max
0.45Kg Min.

01.DR0815 M X XXX XX A XXX

PIN Poles 15:15PIN	Water Code
M/F Differentiates M=Male F=Female	Specification Type
Hsg Color 1=Black 3=Blue 5=Yellow 2=White 4=Green 6=Purple	Hsg Material H1=PB1 HF H2=PA6T HF H3=PA9T HF H4=PA66 HF H5=LCF H10=PB1 H11=PA6T H12=PA9T H13=PA66 H14=PA46
Plating	M00:Matte sn
G00:Gold flash	B00:Bright sn
G01:Gold 1U"	B01:Bright sn 1U"
G03:Gold 3U"	B03:Bright sn 3U"
Gxx:Gold XXU"	Bxx:Bright sn XXU"
	M01:Matte sn 1U"
	M03:Matte sn 3U"
	Mxx:Matte sn XXU"

	DESIGN: 牟 2020.12.15		东莞市跃展精密连接器有限公司 Dongguan YueZhan Precision Connectors Co.,Ltd
	CHECKED: 牟 2020.12.15		
TOLERANCE: X.X ±0.35 X.XX ±0.25 X.XXX ±0.15 Angle ±3.0°	APPROVED: 牟 2020.12.15	PART NO. 01.DR0815MXXXXXXXXXX	DRAW NO.
SCALE:1:1 SIZE:A4		SHEET NO. 01 OF 01	